

5804 Correctionville Road
Sioux City, IA 51106

11
11/19/24

Camp High Hopes Request for Support

Summary:

Camp High Hopes is seeking a financial contribution documented with a resolution letter from the Woodbury County Board of Supervisors of at least \$5,000 to go toward our Multi-Purpose Adaptive Rec Center project. The city of Sioux City has already approved our request for support, contingent upon receiving the support from Woodbury County. Having both the city and county's financial contributions will allow Camp High Hopes to apply for the Iowa Economic Development Authority CAT grant.

What:

Camp needs financial support from Woodbury County to be able to apply for the IEDA-CAT grant. Our project is a perfect fit for this program and could result in a \$500,000-\$900,000 grant.

When:

Approval from the Woodbury County Board of Supervisors would allow us to submit our grant by the end of the year. Review of our application would take place at the IEDA Board meeting on January 17 or February 21 of 2025.

Should we receive \$500,000 in IEDA-CAT grant funding, that would put us at 76% of the way toward our \$4,553,185 goal. At that point, we will go public with the campaign to raise the remaining \$1,095,685. This is also the point at which the Camp High Hopes Board of Directors would be comfortable with starting construction on the rec center. Should this timeline play out, we could begin construction in the spring of 2025.

Where:

The Multi-Purpose Adaptive Rec Center would be built on Camp High Hopes' property located at 5804 Correctionville Rd in Sioux City. This property is owned by the camp and no debts are owed on this property.

Why:

This Multi-Purpose Adaptive Rec Center will allow us to impact more lives! With the rec center, we can add beds, which allows us to enroll more campers during a session and alleviate our waitlists for overnight respite care camp programs. For the past several summers, all of our overnight sleep away camps have been completely full with lengthy waiting lists for each session. That shows are services are wanted and needed. Currently, our arts and crafts classroom and nature education classrooms are located in two rooms in our oldest cabin which was originally designed to be camper and staff sleeping quarters. Once we have the new classrooms completed in the rec center, the current arts and crafts and nature education classrooms will revert back into camper and staff sleeping quarters. That opens up 20 additional beds per night for campers and direct care workers. That's a minimum

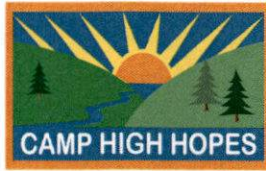

5804 Correctionville Road
Sioux City, IA 51106

increase of at least 100 campers per year! Increasing our camper and staff capacity will allow us to have an even bigger impact on people with disabilities and even more individuals can experience the life-changing benefits of camp. In addition, we anticipate at least a 20% growth in our sleep away camper capacity annually (100 campers), and an overall 40% increase in Iowans impacted by the project (500 additional individuals) each year through visitors, volunteers, partner organizations, and business exchanges coming specifically to use the rec center.

Not only will our campers benefit from this space, but hundreds more in the community each year. We plan to partner with other groups, non-profits, and organizations to make the facility available to others when they are needing an adaptive gym space.

This Multi-Purpose Rec Center project will not only allow us to impact more lives, but it will also allow us to have an even bigger impact on economic development in our area through sports programs and recreational opportunities. Currently, only 37.4%, or 4 out of 10 campers, come from Woodbury County, which means 62.6%, or 6 out of 10 campers, travel in from outside the county to attend camp programs. More than 28% of our campers travel into Iowa from other states. Due to the nature of our campers' abilities, 100% of our campers can't travel by themselves. That means each camper brings at least one parent or caregiver with them when they are getting dropped off or picked up from camp. Often, it's more than one parent or caregiver, and we regularly see entire families coming to camp to pick up their camper. That means Camp High Hopes is not only attracting the camper to come into Woodbury County, Iowa for goods and services, but multiple family members are making that trip to spend money and boost the local economy in Woodbury County.

How:

This Multi-Purpose Rec Center project is part of our larger \$6M Hopes and Smiles Capital Campaign. It's the next phase in our master plan to develop camp and grow our impactful programs. While \$4,553,185 will be used to build the rec center, \$1,446,815 will be used for operations and programs.

Campaign Quick Facts:

- \$6M total campaign goal (roughly a 75% capital/25% operating split)
- \$2,957,500 raised to date for the rec center project (\$1,595,685 left to raise)
- \$1,026,7000 additional raised for operating and program (\$420,115 left to raise)
- Updated bids and pricing were received in August of 2024 to ensure we are on track.
- To date, we have 100% board participation and 100% staff participation in the financial support of this campaign.
- This campaign has been financially supported by individuals and businesses in the community including Mike and Margie Bennett, Regina Roth and empirical foods, Jack and Gail Bernstein, Consumer Supply, and more than 110 others.

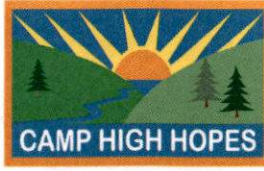

5804 Correctionville Road
Sioux City, IA 51106

Rec Center Quick Facts:

- 14,800 sq ft that includes a gym floor for basketball, pickleball, volleyball, and more, a nature education classroom, an arts & crafts classroom, two locker rooms, an adaptive climbing wall, and storage.
- Will allow camp to expand its program offerings to include things like wheelchair basketball, specialized classes, and other adaptive sports.
- This will provide a dedicated space for indoor activities. Right now, we have to use our lodge during inclement weather or when we need a flat surface for place, but our lodge is also our medical center, sensory/quiet room, cafeteria, kitchen, staff offices, and camp store. So, when an activity is going on in the lodge, it disrupts all other work and activities.
- Built with pre-cast concrete walls and roof, the rec center will provide a large storm shelter for the camp.
- Provide rental opportunities and exchange programs with other groups, non-profits, and organization to enhance community participation, partnerships, and collaboration.



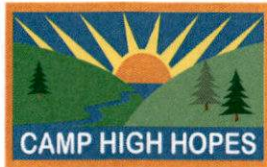

5804 Correctionville Road
Sioux City, IA 51106

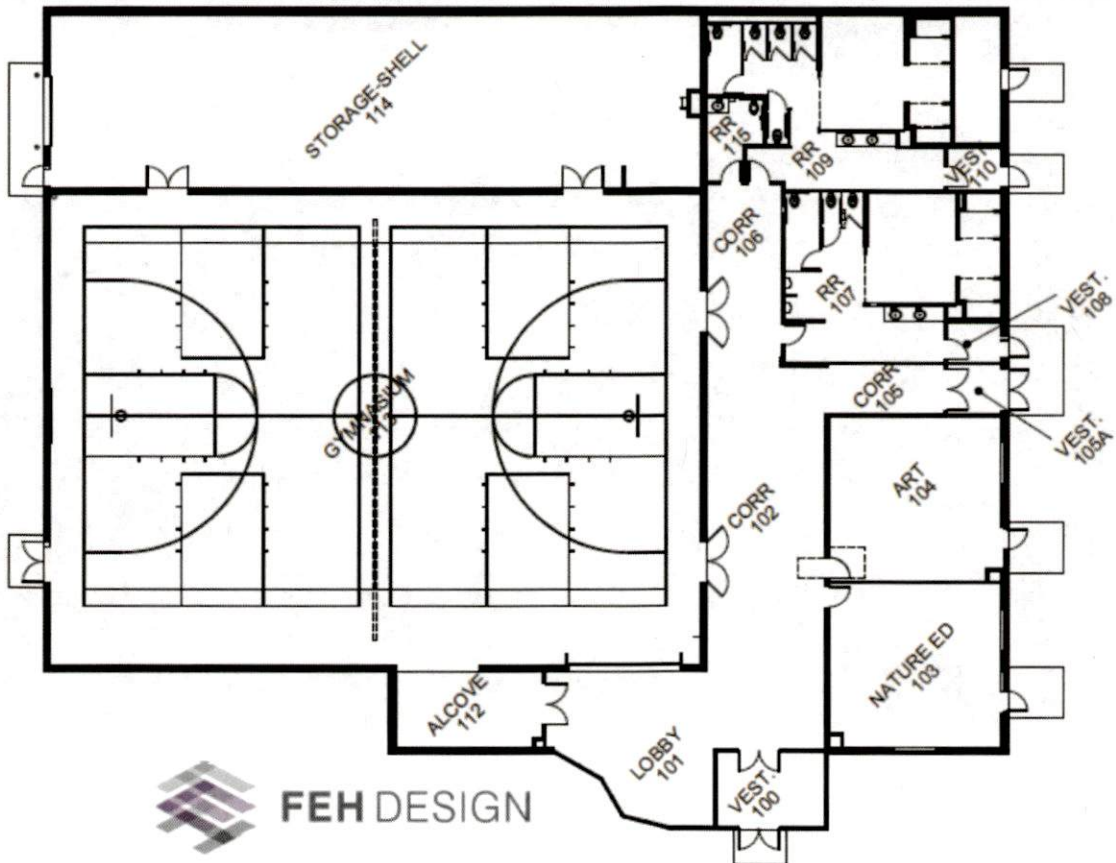

Phone 712-224-2267
www.camphighhopes.com

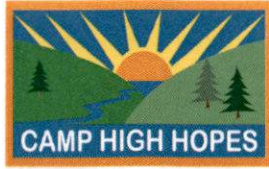

5804 Correctionville Road
Sioux City, IA 51106



Phone 712-224-2267
www.camphighopes.com

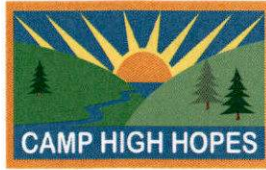

5804 Correctionville Road
Sioux City, IA 51106

Camp High Hopes Quick Facts:

- We serve more than 500 campers each year.
- We are a year-round camp for people of all ages with disabilities.
- Our high-quality programs include experiences in archery, canoeing, outdoor education, swimming, arts and crafts, creative dramatics, and much more.
- The camp was founded in 2004, began construction in 2008, and opened its doors for programs in 2012.
- Our campers are 5-years-old and up and never age out of our programs.
- Programs include fall and spring weekend respite camps and Saturday day camps, summer sleep away camps and day camps, and other social and engaging activities.
- We are the only overnight respite care provider in the region.
- Similar services not available within 300 miles.

