

8a
11/26/24

LETTING DATE
02/18/2025

BRIDGE REPLACEMENT - CCS
PROJ NO. BROS-6021(602)--5F-97

WOODBURY COUNTY

LEGEND

- INTERSTATE HIGHWAY
- PRIMARY HIGHWAY-DIVIDED
- PRIMARY HIGHWAY
- PORTLAND CEMENT CONCRETE ROAD
- ASPHALT ROAD
- BITUMINOUS ROAD
- GRAVEL ROAD
- EARTHEN ROAD
- INTERSTATE HIGHWAY
- UNITED STATES HIGHWAY
- STATE HIGHWAY
- COUNTY HIGHWAY
- RAILROAD
- PIPELINE
- AIRPORT
- HYDROLOGY
- BRIDGE
- STATE BOUNDARY
- COUNTY BOUNDARY
- CORPORATE BOUNDARY
- TOWNSHIP LINE
- SECTION LINE
- ROAD NAMES
- UNINCORPORATED PLACE

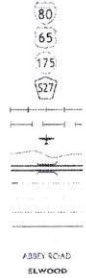

PLANS OF PROPOSED IMPROVEMENTS ON THE
**FARM TO MARKET SYSTEM
WOODBURY COUNTY**
PROJECT NO. BROS-6012(602)--5F-97
**BRIDGE REPLACEMENT - CCS
L25 OVER STREAM**

REFER TO THE PROPOSAL FOR LIST OF APPLICABLE SPECIFICATIONS.

SECTION 404 PERMIT AND CONDITIONS
281-1
10-18-16
CONSTRUCT THIS PROJECT ACCORDING TO THE REQUIREMENTS OF U.S. ARMY CORPS OF ENGINEERS NATIONWIDE, PERMIT NO. 14. A COPY OF THIS PERMIT IS AVAILABLE FROM THE IOWA DOT WEBSITE (<http://www.enrpermits.iowadot.gov>). THE U.S. ARMY CORPS OF ENGINEERS RESERVES THE RIGHT TO VISIT THE SITE WITHOUT PRIOR NOTICE.

ENGLISH STANDARD BRIDGE PLANS

STANDARD	ISSUED	REVISED
J30-01-06	11-2006	09-2020
J30-01A-06	11-2006	09-2020
J30-06E-06	11-2006	09-2020
J30-07E-06	11-2006	09-2020
J30-20-06	11-2006	09-2020
J30-21-06	11-2006	09-2020
J30-23-06	11-2006	09-2020
J30-24-06	11-2006	09-2020
J30-35-06	11-2006	09-2020
J30-39-06	11-2006	09-2020
J30-43-06	11-2006	09-2020
J30-44-06	11-2006	09-2020
J30-45-06	11-2006	09-2020
J30-46-06	11-2006	09-2020
J30-48-06	11-2006	09-2020

TOTAL SHEETS
20

PROJECT NUMBER
BROS-6012(602)--5F-97

FHWA STRUCTURE NUMBER
354551

INDEX OF SHEETS

NO.	DESCRIPTION
1	COVER SHEET
2	QUANTITIES
3	ESTIMATE REFERENCE INFORMATION
4	GENERAL NOTES
5	SITUATION PLAN
6	PLAN AND PROFILE
7	RIGHT OF WAY LAYOUT
8	TOP OF SLAB ELEVATIONS
9	TYPICALS AND TABULATIONS
10	TABULATIONS
11	DETOUR LAYOUT
12	BORING LOGS
13-20	CROSS SECTIONS

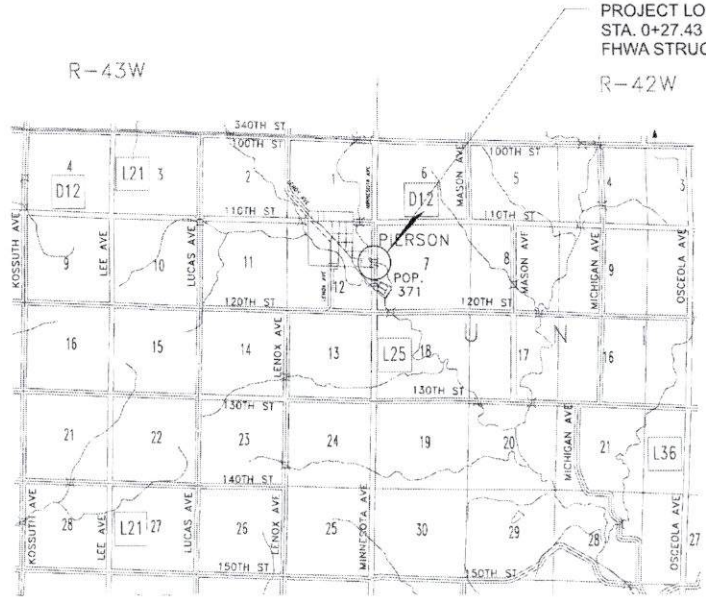

PROJECT LOCATION
STA. 0+27.43 TO STA. 6+90.00
FHWA STRUCTURE NO. 354551

IOWA ONE CALL
1-800-292-8989
www.iowaonecall.com

MATTHEW UNG (CHAIRMAN)
DANIEL BITTINGER II (VICE CHAIRMAN)
MARK NELSON
KEITH RADIG
JEREMY TAYLOR
BOARD OF SUPERVISORS

REVISIONS

APPROVAL
LAURA BIEVERS (WOODBURY COUNTY ENGINEER)
11/26/24
DATE

DESIGN DATA RURAL

2023 AADT	220	V.P.D.
2048 AADT	360	V.P.D.
2048 DHV		V.P.H.
TRUCKS		%
Total Design ESALs		

STANDARD ROAD PLANS
STANDARD ROAD PLANS ARE LISTED ON SHEET 9

INDEX OF SEALS

SHEET NO.	NAME	TYPE
1	JONATHAN E. PETERSON	HYDRAULIC DESIGN
1	JONATHAN E. PETERSON	STRUCTURAL DESIGN
1	JONATHAN E. PETERSON	CIVIL DESIGN

CIVIL, STRUCTURAL AND HYDRAULIC DESIGN

I hereby certify that this engineering document was prepared by me or under my direct personal supervision and that I am a duly licensed Professional Engineer under the laws of the State of Iowa.

Jonathan E. Peterson
11-19-2024
Date

My license renewal date is December 31, 2024.

Pages or sheets covered by this seal: SHEETS 1 THRU 20

BENCHMARKS:

CP #1 - ELEVATION = 1283.51
N = 3669270.90
E = 4285451.69

CP #2 - ELEVATION = 1263.18
N = 3668962.83
E = 4285336.18

CP #3 - ELEVATION = 1286.67
N = 3668568.99
E = 4285453.64

CP #4 - ELEVATION = 1285.72
N = 3668733.64
E = 4285418.78



0 ENGLISH 20
SCALE 1/4" FEET

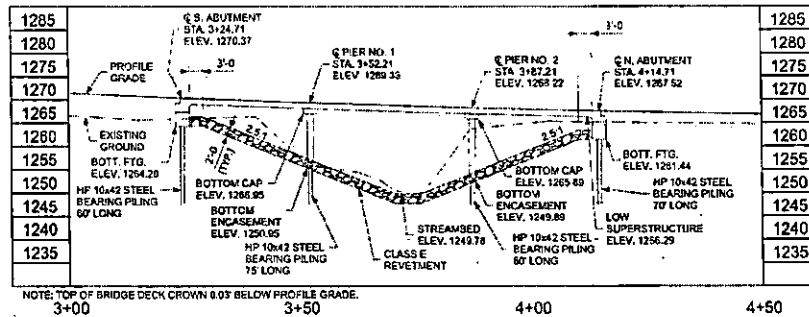

NOTE: TOP OF BRIDGE DECK CROWN 0.07' BELOW PROFILE GRADE.

LONGITUDINAL SECTION ALONG \bar{C} ROADWAY

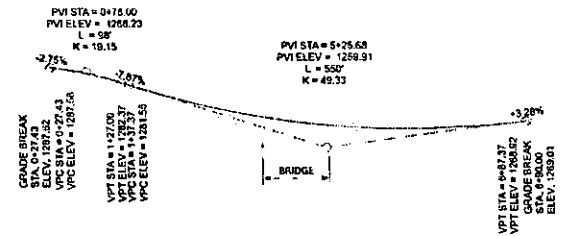

PROPOSED PROFILE GRADE
MINNESOTA AVE.

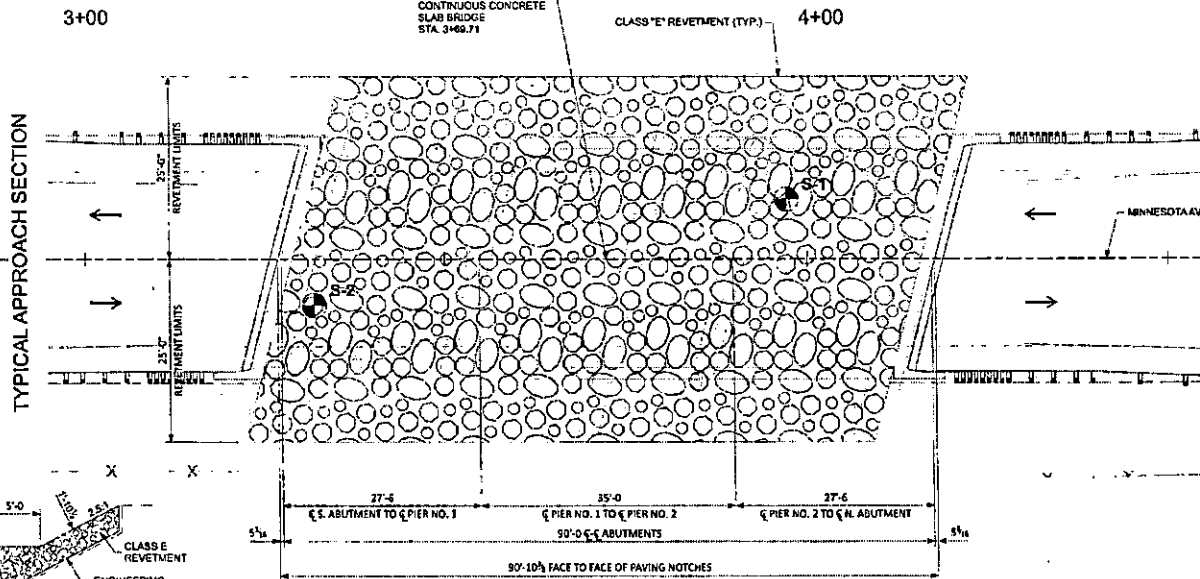

TYPICAL APPROACH SECTION

SITUATION PLAN

STREAMBANK
REVESTMENT DETAIL

NOTES:
1. 4 BRIDGE RAILING PROPOSED.
ALL UNITS ARE IN FEET UNLESS OTHERWISE NOTED.

HYDRAULIC DATA:

Drainage Area = 4.5 Sq. MI
Stream Slope = 30.9 FT/MI
Avg. Low Water Stage = 1,250.66'

Q_{10} = 1,970 CFS

Stage = 1,258.88'

Q_{25} = 2,430 CFS

Stage = 1,259.73'

Regulatory Low Beam = 1,267.20'

Avg. Bridge Velocity = 6.40 FPS

Q_{50} = 2,600 CFS

Stage = 1,259.73'

Operational Low Beam = 1,265.86'

Backwater = 0.06' Ft.

Avg. Bridge Velocity = 7.20 FPS

Q_{100} = 3,770 CFS

Stage = 1,260.40'

Calculated Design Scour = 1,249.78'

Q_{150} = 4,160 CFS

Stage = 1,260.40'

Avg. Bridge Velocity = 9.0 FPS

Calculated Check Scour = 1,249.78'

LOCATION

MINNESOTA AVE.
PIERSON TOWNSHIP
WOODBURY COUNTY
FIRMA NO. 334551
LATITUDE: 42.5411°
LONGITUDE: -95.0594°

DESIGN FOR 15° SKEW
90'-0" X 30'-0"
CONTINUOUS CONCRETE SLAB BRIDGE
SITUATION PLAN

STA. 0+27.43 SEPTEMBER, 2024
WOODBURY COUNTY
IOWA DEPARTMENT OF TRANSPORTATION - HIGHWAY DIVISION

0+00 1+00 2+00 3+00 4+00 5+00 6+00 7+00

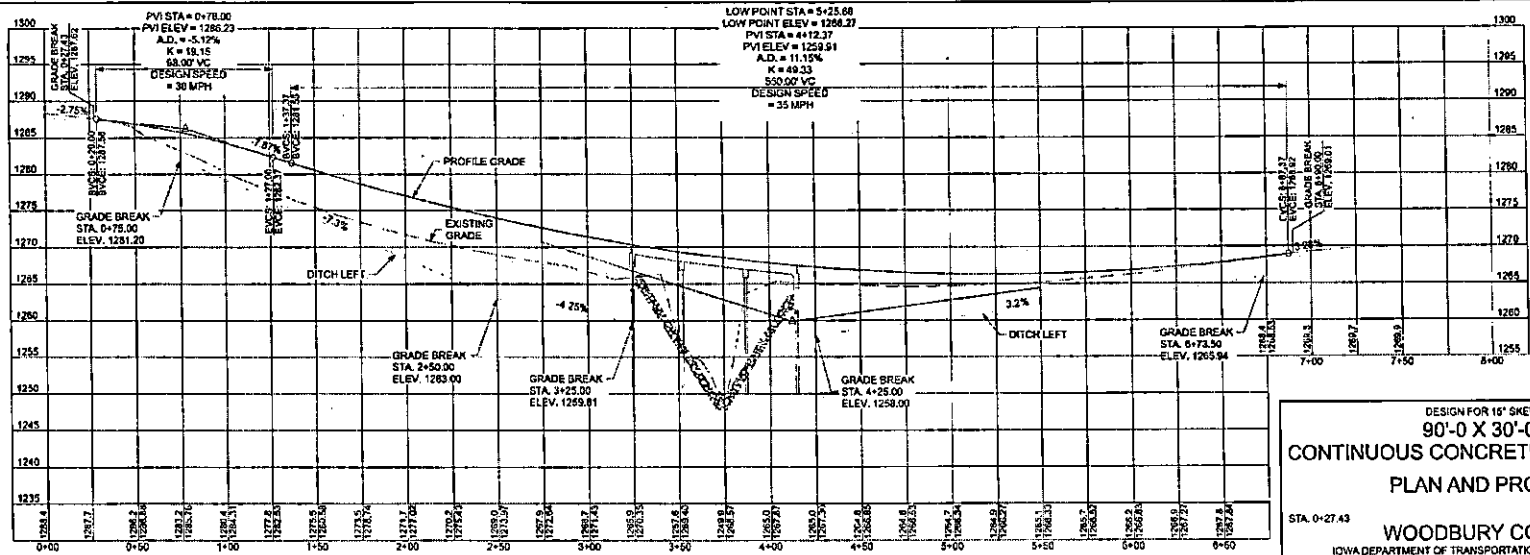
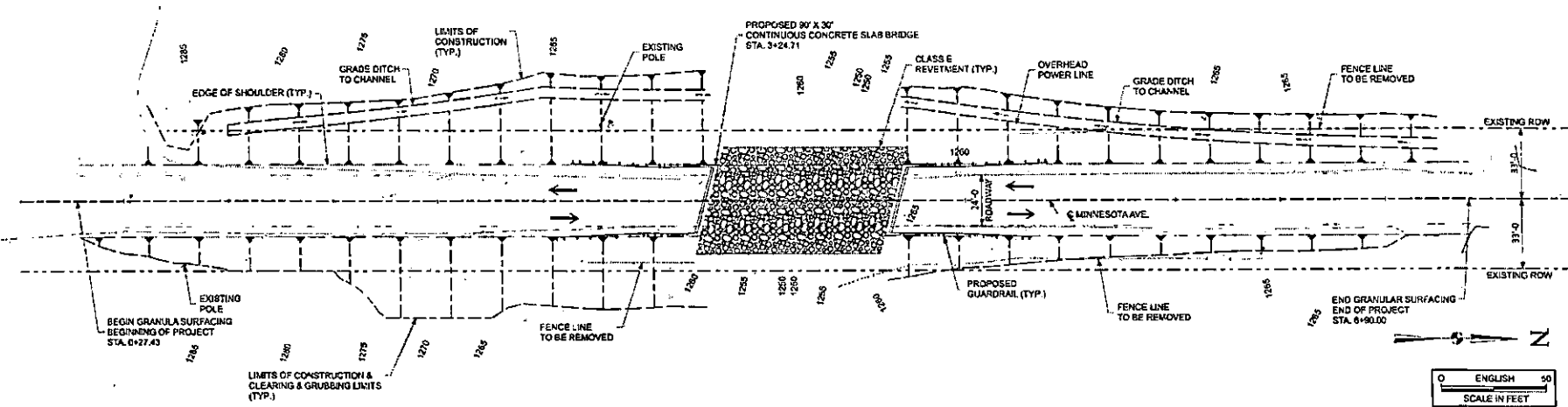

DESIGN FOR 16' SKEW
90'-0 X 30'-0
CONTINUOUS CONCRETE SLAB BRIDGE
PLAN AND PROFILE
 STA. 0+27.43 SEPTEMBER, 2024
WOODBURY COUNTY
 IOWA DEPARTMENT OF TRANSPORTATION - HIGHWAY DIVISION

TOP OF SLAB ELEVATIONS

LOCATION	C WEST ABUTMENT BEARING				C PIER NO. 1	C PIER NO. 2				C EAST ABUTMENT BEARING			
	LINE 1	LINE 2	LINE 3	LINE 4		LINE 5	LINE 6	LINE 7	LINE 8		LINE 9	LINE 10	LINE 11
EDGE OF SLAB LEFT (ESL)	1268.24	1269.58	1269.32	1269.07	1269.83	1268.54	1268.26	1268.99	1267.76	1267.57	1267.49	1267.24	1267.29
INTERMEDIATE LINE A	1270.05	1269.78	1269.51	1269.29	1269.02	1268.73	1268.45	1268.18	1267.93	1267.75	1267.58	1267.41	1267.26
CROWN LINE B	1270.25	1269.99	1269.72	1269.47	1269.22	1268.93	1268.64	1268.38	1268.13	1267.94	1267.76	1267.59	1267.44
C APPROACH ROADWAY	1270.32	1270.05	1269.78	1269.53	1269.28	1268.98	1268.70	1268.43	1268.15	1267.90	1267.61	1267.44	1267.49
CROWN LINE C	1270.33	1270.05	1269.79	1269.53	1269.28	1268.98	1268.70	1268.43	1268.17	1267.98	1267.80	1267.63	1267.47
INTERMEDIATE LINE D	1270.28	1269.98	1269.72	1269.46	1269.21	1268.92	1268.62	1268.34	1268.08	1267.89	1267.71	1267.54	1267.38
EDGE OF SLAB RIGHT (ESR)	1270.21	1269.92	1269.65	1269.39	1269.14	1268.83	1268.54	1268.26	1268.00	1267.81	1267.63	1267.45	1267.28

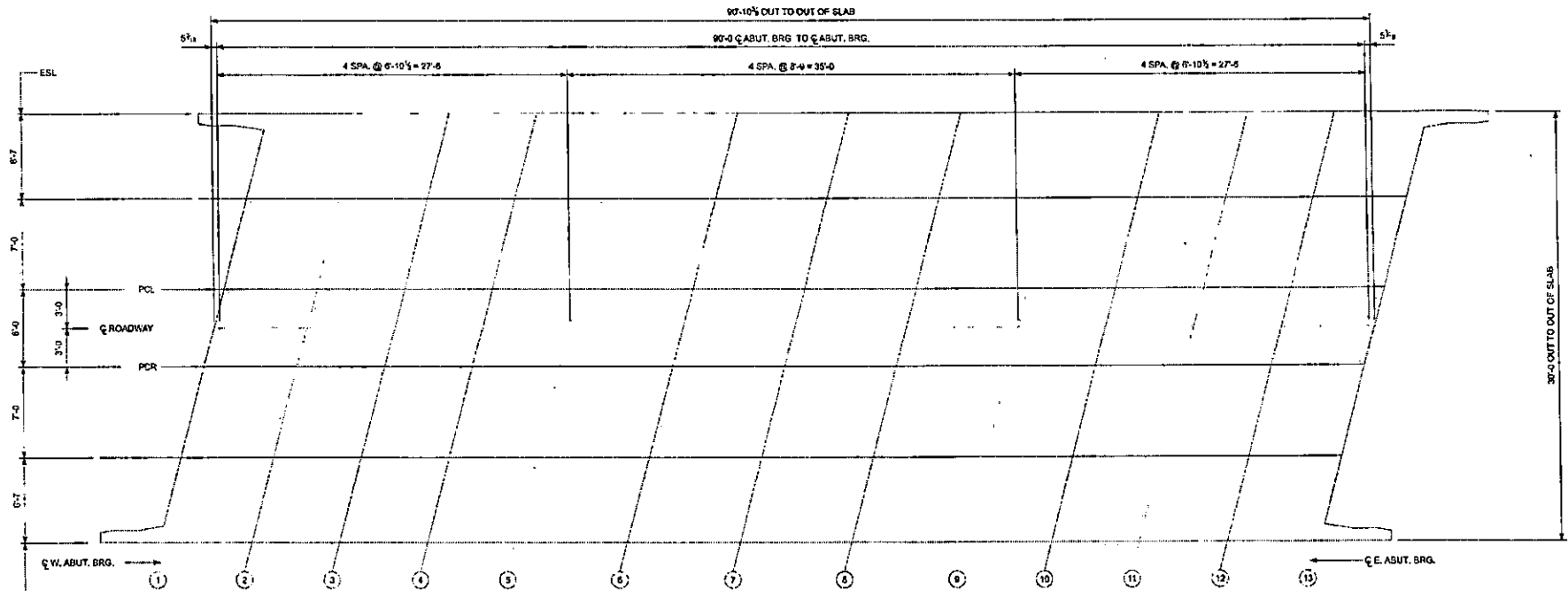

SLAB ELEVATION PLAN

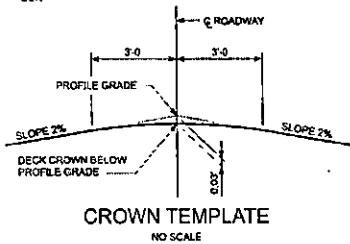

DESIGN FOR 16° SKEW
 90'-0" X 30'-0"
 CONTINUOUS CONCRETE SLAB BRIDGE
 TOP OF SLAB ELEVATIONS
 STA. 0+27.43 SEPTEMBER, 2024
 WOODBURY COUNTY
 IOWA DEPARTMENT OF TRANSPORTATION - HIGHWAY DIVISION

TRAFFIC CONTROL PLAN

WOODSBURY COUNTY, ILLINOIS AND MARIAS BLANKS ROUTE AND BRIDGE THROUGHOUT THE DURATION OF THE PROJECT

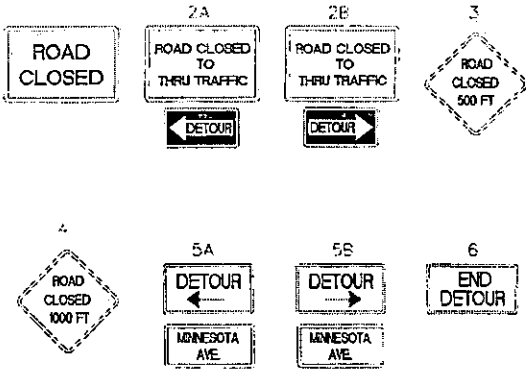
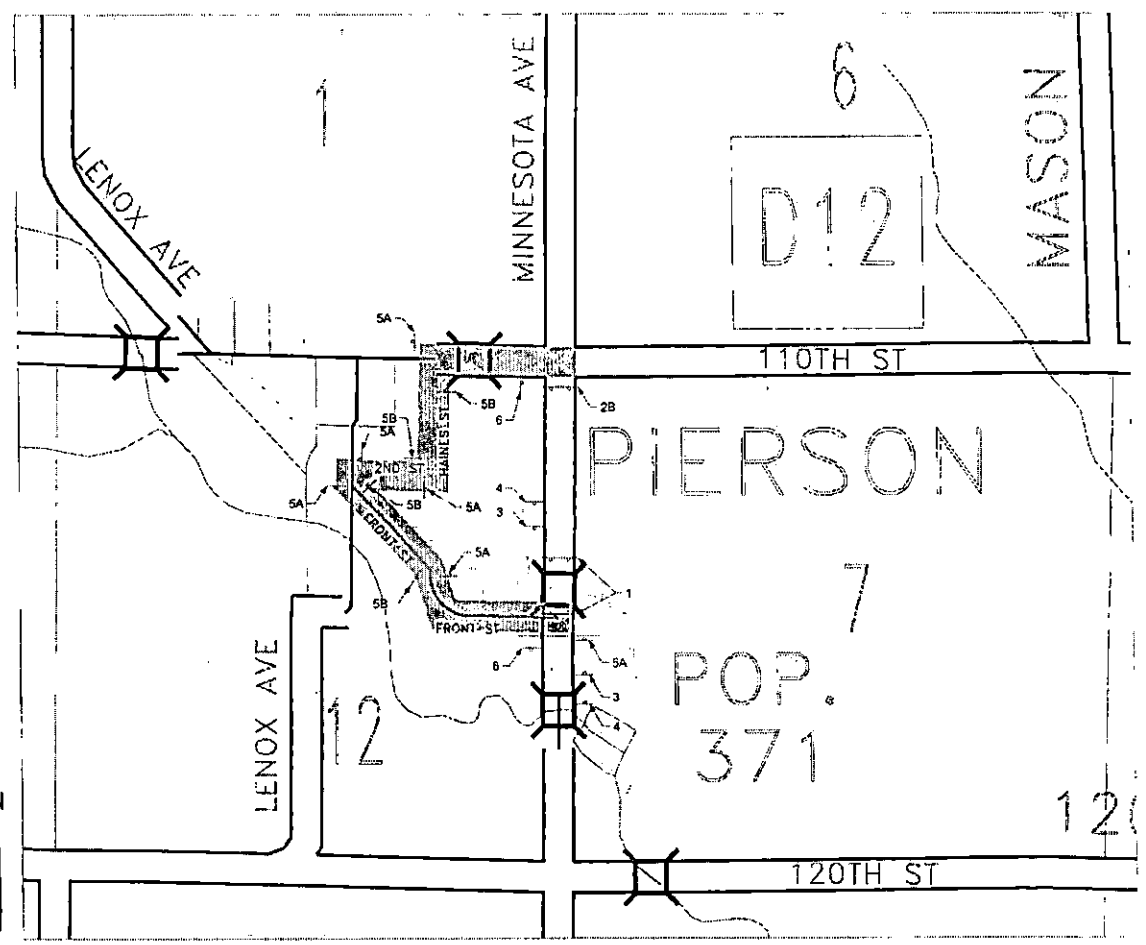

LEGEND

- DETOUR ROUTE
- PROJECT AREA
- ROAD CLOSURE
- - - TRAFFIC SIGN

DESIGN FOR 13' SKEW
 90'-0" X 30'-0"
CONTINUOUS CONCRETE SLAB BRIDGE
 DETOUR SHEET

STA. 0+27.43 SEPTEMBER, 2024
WOODSBURY COUNTY
 IOWA DEPARTMENT OF TRANSPORTATION - HIGHWAY DIVISION

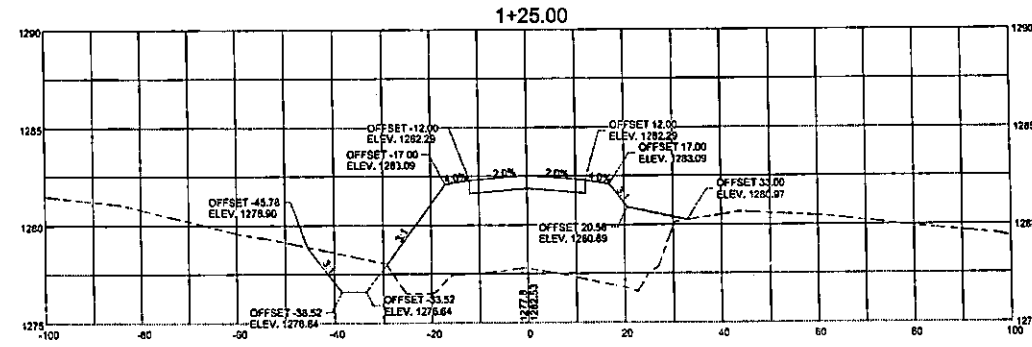
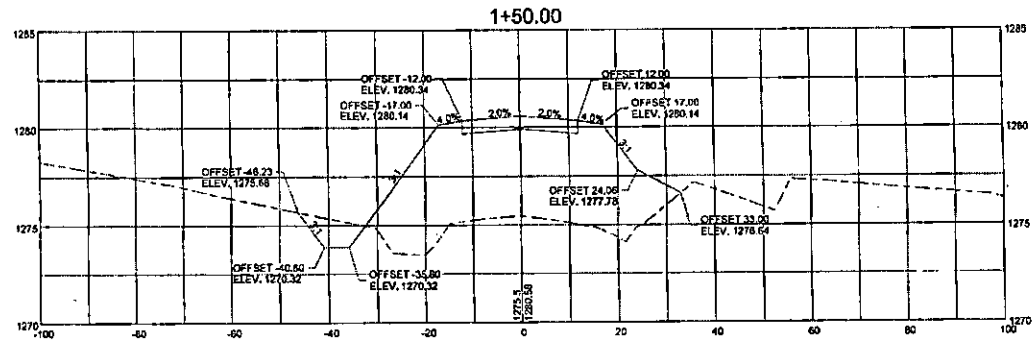
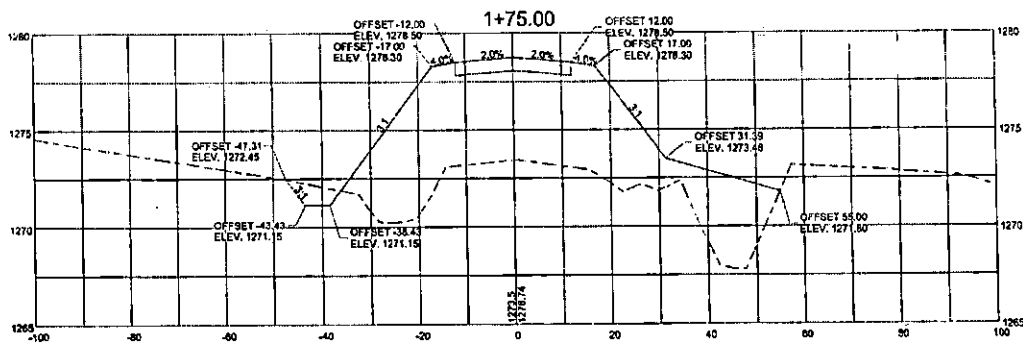

DESIGN FOR 15° SKEW
 90'-0" X 30'-0"
 CONTINUOUS CONCRETE SLAB BRIDGE
 CROSS SECTIONS (2 OF 8)
 STA. 0+27.43 SEPTEMBER, 2024
 WOODBURY COUNTY
 IOWA DEPARTMENT OF TRANSPORTATION - HIGHWAY DIVISION

