

Woodbury County Secondary Roads Department

759 E. Frontage Road • Merville, Iowa 51039
Telephone (712) 279-6484 • (712) 873-3215 • Fax (712) 873-3235

89,
3/18/25

COUNTY ENGINEER
Mark J. Nahra, P.E.
mnahra@sioux-city.org

ASSISTANT TO THE COUNTY ENGINEER
Benjamin T. Kusler, E.I.T.
bkusler@sioux-city.org

SECRETARY
Tish Brice
tbrice@sioux-city.org

WOODBURY COUNTY SECONDARY ROAD DEPARTMENT

PERMIT & AGREEMENT TO PERFORM WORK WITHIN WOODBURY COUNTY RIGHT OF WAY

Name of Permittee: BRUCE + Rochelle SORENSEN LIVING TRUST Phone No.: 712-251-1503
Mailing Address: 1364 DALLAS AVE. LAWTON, IA 51030
Township: BANNER Section: 31

CONSTRUCTION SITE
Woodbury County, State of Iowa, and BRUCE SORENSEN (hereinafter referred to as property owner, organization or authorized representative) do hereby enter into the following permit and agreement:

1. Woodbury County hereby consents to and grants permission to the property owner, organization or authorized representative, to conduct the following described construction or activities within the right-of-way:
AUTHORIZED CONTRACTOR (LIEBER CONSTRUCTION) Initially we will load Trucks on shoulder of right of way, on top of hill in Section 31 Banner once enough dirt is removed we will move onto my property. Leveling hill to achieve an access.

2. In consideration of Woodbury County granting said permission and consent, the property owner, organization or authorized representative hereby promises and agrees to the following:
 - A. The applicant shall carry on the construction, repair and maintenance with serious regard to the safety of the traveling public and adjacent property owners.
 - B. The property owner, organization or authorized representative, at his/her own expense, shall provide all safety measures and warning devices necessary to protect the traveling public such as but not limited to, signs, lights, and barricades during the day and at night if the roadway will be obstructed. Traffic protection shall be in accordance with Part VI of the current Manual on Uniform Traffic Control Devices for Streets and Highways. The Department will loan the required signs to the applicant who shall be responsible for placing the signs and covering or removing when not in use, removal after the work has been completed, and return of the Department owned signs to the Department maintenance facility from which obtained. The applicant shall be responsible for correctly using signs as needed while work is in progress. Flagging operations are the responsibility of the applicant.
 - C. In placing any drainage structure, no natural drainage course will be altered or blocked.
 - D. The finished project shall be left in a satisfactory condition subject to the approval of the County Engineer. The traveled portion of the roadway shall not be damaged or disturbed. The property owner, organization or authorized representative assumes all liability and agrees to reimburse Woodbury County for any damage to the roadway or ditch caused by placement of this structure. Permittee is to call County Engineer for upon completion for final inspection.
 - E. The property owner, organization or authorized representative shall notify all appropriate telephone and utility companies in advance of any excavation and shall check for underground electric or telephone lines.

F. Woodbury County will not assume any of the cost of the construction of the said improvement or structure nor will Woodbury County assume any future costs for maintenance or replacement of said improvement or structure. If in the best interest of Woodbury County, the said improvement or structure may be removed by the County, or may be caused to be removed, without any obligation by Woodbury County to pay damages or cost of replacement.

G. Property owner, organization or authorized representative will reseed and mulch the disturbed areas. Property owner, organization or authorized representative will be responsible for seed, mulch, and labor unless otherwise provided in section L.

H. The property owner, organization, or authorized representative hereby agrees to hold Woodbury County and the Woodbury County Secondary Road Department, its employees and agents harmless against any and all claims for damages and personal injury arising out of work performed or actions taken by the applicant related to the construction or maintenance of the facility. The applicant further agrees to reimburse the County or the Department for any expenditures that the County or Department may have to make on said highway rights of way on account of said applicant's construction or maintenance activity or other activities or lack thereof. The applicant shall also save Woodbury County and the Woodbury County Secondary Road Department harmless of any damage or losses that may be sustained by the traveling public on account of such construction, repair or maintenance operations, or other activities.

I. FAILURE TO CONFORM TO OR TO ACQUIRE A PERMIT IS A VIOLATION OF SECTION 318.8, 2009 CODE OF IOWA. This permit is subject to any laws now in effect or any laws that may be hereafter enacted and all applicable rules and regulations of local, state and federal agencies. This permit is subject to all the rules and regulations of Woodbury County and the Woodbury County Secondary Road Department.

J. This permit is subject to revocation by the Department at any time and at no cost to the Department, when in the judgment of the Department it is necessary in the improvement or maintenance of the highway or for other reasonable cause.

K. All proposed work covered by this permit shall be at the applicant's expense. The applicant shall reimburse the Woodbury County Secondary Road Department for any materials removed from the highway right of way described as follows:

*Currently the Embankment falls on to the right of way.
No funds are needed from the county.*

L. Woodbury County agrees to provide the following contribution toward completion of this project:

NONE

M. All work done by property owner, organization or authorized representative pursuant to this agreement shall be completed prior to the 1st day of April, 2025

Entered into this 26th day of February, 2025

Bruce Sorensen for Bruce & Rochelle Sorensen Trust.
Signature of Property Owner or Authorized Representative

[Signature]
Woodbury County Engineer

[Signature]
Chair, Woodbury County Board of Supervisors

WOODBURY COUNTY HIGHWAY DEPARTMENT

COUNTY ENGINEER'S OFFICE

(Permit application for entrance to County Secondary Road)

Permit Number _____

Applicant Bruce & Rochelle Sorenson Living Trust
(Owner or Owners of Record)

Address 1364 Dallas Ave Date 2-26-2025, 2025

A permit is hereby requested for a Driveway entrance
(Field or Driveway) Eastland Ave

access into Woodbury County Secondary Road right-of-way.

Proposed entrance is located between _____ and _____
(Road Name) (Road Name)

on 150th St., on the North line of Sec. 31, T 89 N,
(Road Name)

R 45 W, Civil Township Banner

More specifically described as follows:

Top of hill west of intersection of
150th Street & Eastland Ave.
Close to house address of 2086
150th Street - South side of road.

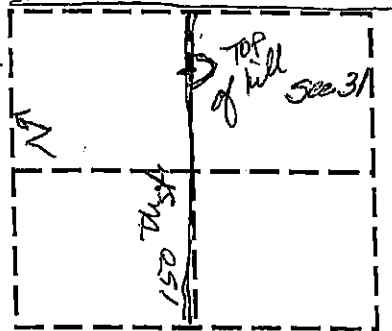

(Mark location by X)

The applicant agrees that if granted a permit for the above-described entrance, the following stipulations shall govern.

1. If in the opinion of the Woodbury County Engineer a culvert pipe is needed in said entrance for proper drainage, the applicant will pay Woodbury County for furnishing said culvert pipe. Woodbury County will install said culvert pipe and build drive or entrance at no further cost to the applicant. If in the opinion of the County Engineer a Culvert Pipe is not necessary, Woodbury County will build drive or entrance at no cost to the applicant.
2. Non-compliance with any of the terms of the Highway Department policy, permit, or agreement, may be considered cause for revocation of the permit. The cost of any work caused to be performed by the County in removal of non-complying construction will be assessed against the applicant.
3. Stipulations and requirements contained herein are not intended to waive greater requirements of any local zoning ordinance.

Applicant's Cost: Farm Address - 1364 Dallas Ave,
Lawton, OK. 57070

Signed Bruce Sorenson Telephone 712-251-1503
(Applicant (Owner or Owners of Record))

Address 6701 Conceptionville Rd. Lawton, OK. 57106

Recommended for approval by [Signature]
Engineering Department

Recommended for approval by _____
Zoning Administrator [Signature]